

# Century Upgrades

## Head Button

(Hawk, Falcon & Phoenix)

Left hand threaded  
Black or Purple  
anodized head button  
for easy stopping of  
the rotor head.

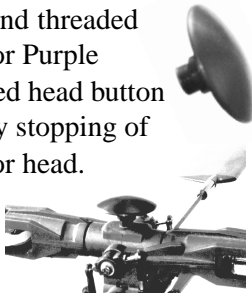

CN2215B Black  
CN2215P Purple

## O.S. Mixture Adjustment Screws

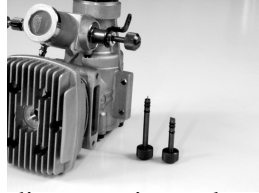

Idle adjustment is nearly  
impossible with the scale  
mufflers, these mixture screws  
make the task much easier.

CN2030A Idle Screw Short

## Autorotation Slipper Unit



This slipper unit will drive the  
tail rotor during autorotations,  
providing accurate rudder control  
while descending and landing.

CN2231A Slipper Clutch

## Ball Bearing Upgrade



Upgrade your Hawk IV cyclic  
control system to the number of  
bearings in the Hawk SE. Now  
all control bellcranks and arms  
will be ball bearing supported.

CNBB1001 Bearing upgrade

## Machined Elevator Arm w/ Ball Bearing

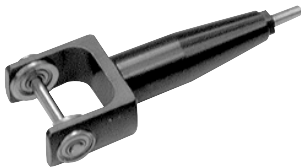

Incredible smooth operation and  
improved design allows easy  
replacement of the ball link when  
slop develops.

CNQCSC04 BB elevator arm

## Ball Link Sizing Tool



Ball link resizing tool. Adjust-  
able to fit multiple require-  
ments. Requires a simple twist  
to perfectly match links to balls.

CN2215 Ball Link Sizing Tool

## Carbon Fly Bar Stiffener



Carbon fiber flybar stiffener with  
purple aluminum ends will  
increase precision control for all  
flight maneuvers. (3mm flybars)

CN2122 for Hawk IV

## Metal Swash Plate Anti-rotation Bracket

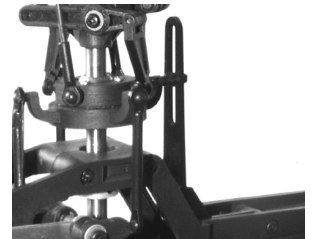

Improves timing precision of the  
swash plate (purple or black)

CN2208P Purple  
CN2208B Black

## Ball Link Driver



A specially designed tool for  
quick installation and removal  
of plastic ball links without  
damage.

CN2219 Ball Link Driver

## Aluminum Clutch Bell

CNC precision machined alumi-  
num clutch bell with  
replaceable  
gear and  
lining



CN2225 Clutch bell w/gear  
HI3010A Bell only  
HI3010B 2-Stroke Gear (26T)  
HI3010C 4-Stroke Gear (33T)  
CN2020L Clutch lining (2)

## Precision Metal Swashplate



This beautiful CNC precision  
machined aluminum swashplate  
will increase precision control for  
all flight maneuvers. (Silver)

CN2056A Metal Swashplate 10mm

## SE 6 mm Head Axle with Thrust Bearings

The 6mm spindle takes the high  
"G" stresses of 3D better and  
the thrust bearings make for  
smoother pitch control at high  
rotor speeds



CN2221 Conversion Kit

## Carbon Tail Servo Mount

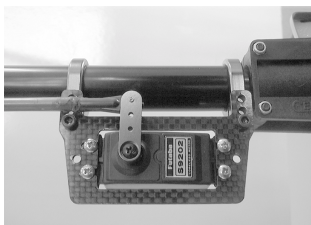

Mount the tail servo onto this  
aluminum/carbon mount for a  
more direct control rod path to  
the tail rotor bellcrank.

CN2239C Tail Boom Servo Mount

## 2 oz Sub Tank w/ CNC Machined or Die-cut Mount

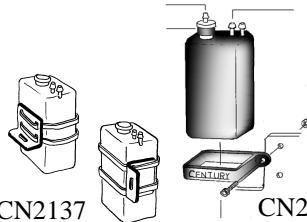

CN2137

CN2213 Machined Mount  
CN2137 Die Cut Mount

## Aluminum Turbo Cooling Fan



Increased air flow, lower engine  
drag, cooler and smoother high  
speed operation & cooler clutch  
shoes.

CN2202 Turbo cooling fan

# CENTURY

HELICOPTER PRODUCTS

Century Helicopter Products  
523 Sinclair Frontage Rd.  
Milpitas, CA 95035  
Tel: (408) 942-9525  
Fax: (408) 942-9524  
Web: [www.centuryheli.com](http://www.centuryheli.com)

All rights reserved. No part of this publication may be reproduced, stored in a retrieval system or transmitted in any form or by any means, electronic, mechanical, photocopying, recording or otherwise, without the prior written permission of the publisher, Century Helicopter Products.